



TASMAN 80



TASMAN
BOATS



TASMAN 80



TASMAN
BOATS



TASMAN 80





TASMAN 80





TASMAN 80



TASMAN
BOATS

JULY 2023



TASMAN BOATWORKS 80 SPECIFICATIONS

LOA:	8.0 M	CRUISE SPEED:	28 KNOTS
BMAX:	2.8 M	RANGE AT CRUISE:	355 NM @ 28KNOTS, WITH 10% RESERVE
DRAFT:	0.77 M FULL LOAD	DIESEL ENGINE:	1 X YANMAR 8LV370, 370HP AT 3800 RPM
WEIGHT:	2450KG LIGHTSHIP, 4270KG FULL LOAD (EST.)	DRIVE:	SHAFT DRIVING PROP. IN TUNNEL
CONSTRUCTION:	VACUUM INFUSED COMPOSITES	BOW THRUSTER:	ELECTRIC TUNNEL 40KG.F
DESIGN STANDARD:	AS1799/NSCV	FUEL:	650 LITRES
MAXIMUM SPEED:	40 KNOTS HALF LOAD	WATER:	150 LITRES

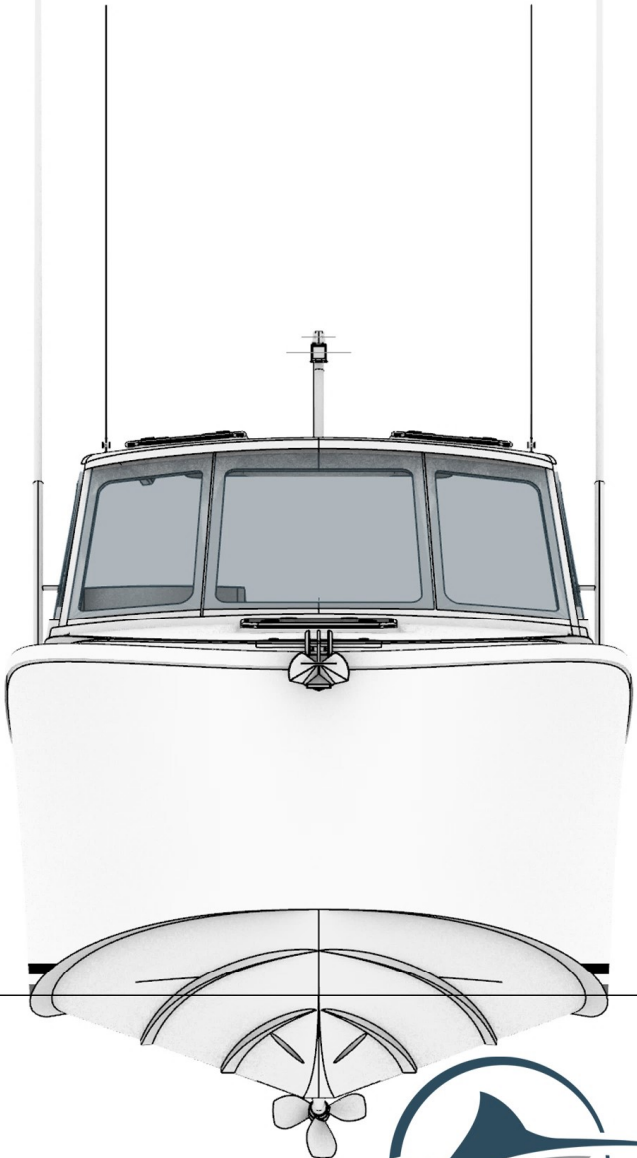

TASMAN 80



STANDARD INCLUSIONS

- BUILT TO AS1799/AMSA COMMERCIAL STANDARDS
- FOAM FLOATATION AND WATERTIGHT COMPARTMENTS
- VINYL ESTER VACUUM RESIN INFUSED HULL
- VACUUM RESIN INFUSED DECK, CABIN COCKPIT AND INTERIOR
- NO TIMBER USED IN VESSEL, 100% COMPOSITE
- YANMAR 8LV 370HP WITH KMH50A GEARBOX
- DUPLEX STAINLESS STEEL SHAFT 50MM, 4 BLADE BRONZE PROPELLER IN TUNNEL
- DRIPLESS SHAFT SEAL
- WATER COOLED EXHAUST WITH FRP WATERLIFT MUFFLER
- FULLY INSULATED ENGINE COMPARTMENT WITH DECK ACCESS HATCH
- ULLAGE BASED FUEL FILLER SYSTEM (NO OVERFILLS)
- TWIN 325 LITRE, FRP VINYL ESTER FUEL TANKS
- INTEGRATED WATER BALLAST SYSTEM W. ELECTRIC TRANSFER PUMP
- 2 X BILGE PUMPS WITH FLOAT SWITCHES
- 60 LITRE PLUMBED LIVE BAIT TANK
- 2 BATTERY SYSTEM, HOUSE AND STARTING
- CUSTOM 12V SWITCHBOARD
- LED HOUSE AND RUNNING LIGHTS
- 150 LITRE FRP WATER TANK AND 12V PRESSURE PUMP
- ELECTRIC MARINE TOILET AND BATHROOM SINK IN ENCLOSED HEAD
- TOUGHENED GLASS WINDOWS IN CABIN
- FIXED FRONT CABIN WINDOW, SLIDING SIDE GLASS
- 2 X CABIN ROOF HATCHES
- 1 X FOREDECK HATCH
- LONESTAR ANCHOR WINCH/ROLLER WITH CHAIN/ROPE/ANCHOR
- FWD DECK LOCKER WITH HATCH
- STAINLESS STEEL/BRONZE RUDDER, SHAFT AND TILLER
- HYDRAULIC STEERING
- ZIPWAKE INTERCEPTORS
- 40KG.F SLEIPNER ELECTRIC BOW THRUSTER
- HELM SEAT BOXES WITH UPHOLSTERED SEAT CUSHION & BOLSTER
- STARBOARD SINK/TACKLE STATION
- PORT SEAT BOX WITH FWD LOCKER AND INSULATED ICE CHEST AFT
- PORT UPHOLSTERED SEAT CUSHION & BACK TO BACK BOLSTER
- TWIN INSULATED KILL TANKS/COCKPIT FLOOR LOCKERS
- MOULDED SIDE POCKETS PORT AND STARBOARD
- SELF DRAINING COCKPIT
- TRANSOM DOOR
- LINED FORWARD CABIN

OPTIONS

- PORT TWIN MOULDED INSULATED SEAT BOXES WITH REMOVABLE TABLE, CONVERTING TO BERTH
- PORT BENCH SEAT WITH AFT COMPARTMENT INSULATED
- 65L DRAW FRIDGE IN STARBOARD SEATBOX
- FRIDGE PLATE/COMPRESSOR FITTED TO INSULATED ICE CHEST PORT SIDE
- HOT WATER SYSTEM
- FWD CABIN CUSHIONS
- MECHANICAL SALT WATER DECK WASH PUMP
- WINDSCREEN WIPER FOR HELM SIDE
- BOW AND COCKPIT RAILS
- ROOF RAILS AND ROCKET LAUNCHERS
- SWIM PLATFORM
- HULL AND DECK GELCOAT COLOUR OPTIONS
- FLEXI-TEAK DECKING IN COCKPIT/AFT SIDE DECKS
- FULL COMMERCIAL SURVEY TO AMSA/NSCV STANDARDS (2C, 3B/C)

NAVAL ARCHITECTURE BY 

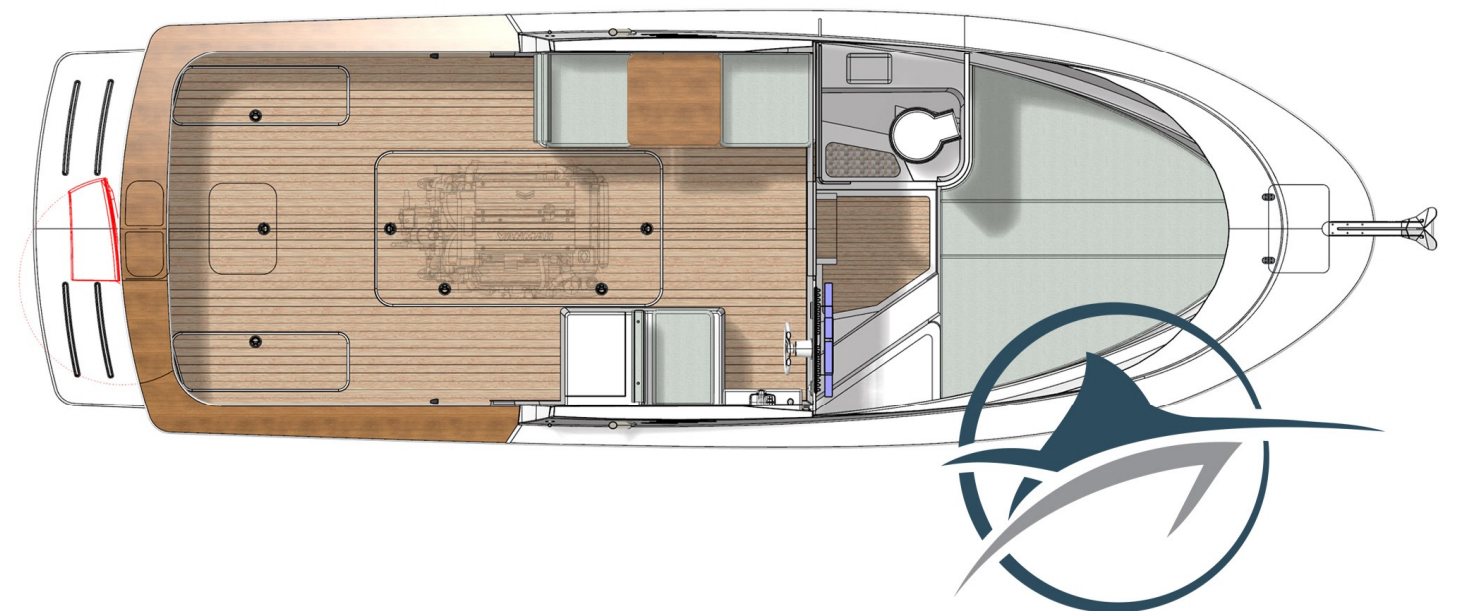

TASMAN 80

TASMAN

BOATS

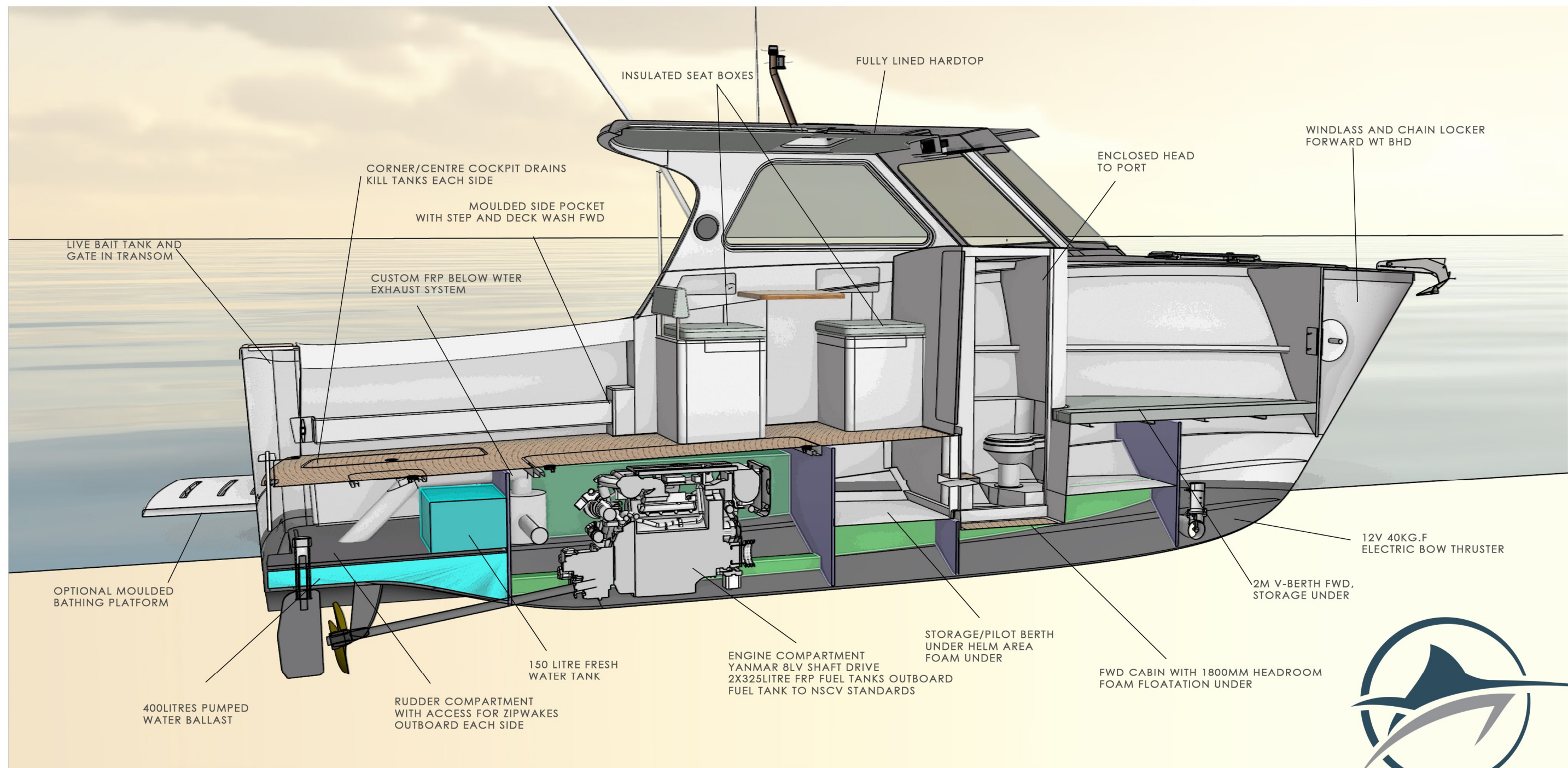

TASMAN 80

TASMAN
BOATS



TASMAN 80

